

Installation Instructions



Green Mamba

Model No. 4591-81GM

Revision A: 9/6/2024

All Rights Reserved

© Copyright 2024, NetPlay USA LLC

Contents

Introduction.....	2
General Information.....	2
Drawings/Views.....	2
Measurement Tolerances	2
Specifications	3
Parts List	4
Installation	5-13
Part A: Site Prep and Use Zone	5
Part B: Anchor Posts.....	6-10
Part C: Rope Assembly Installation.....	11-13
Finishing.....	14
Final Checklist.....	14
Maintenance.....	15
Maintenance Log.....	16
Handover Document.....	17



Please read through the entire installation instructions upon receipt to ensure that all parts have been received prior to the start of installation.

Introduction

Thank you for purchasing the Green Mamba! Before we begin, please take some time to familiarize yourself with the components, tools, and installation steps to ensure adequate preparation for a smooth installation.

General Information

This equipment should be installed, inspected, maintained, and operated in accordance with ASTM F1487 or CSA-Z614 guidelines.

The installation site shall have a flat and level surface with a maximum slope of 3%.

For product support, including questions regarding installation, or to obtain replacement parts, please contact your equipment dealer.



Following installation, the complete assembly instructions, maintenance instructions, and maintenance records must be sent to the operator who must confirm receipt in writing. See the last page of this document.

We hereby confirm that this play equipment complies with the play equipment standards ASTM F1487 and CSA-Z614 when properly installed. NetPlay USA LLC is not liable for changes to laws or standards which are enacted after equipment installation.

Drawings/Views

The manufacturer reserves the right to make reasonable changes to technical details of our products for enhanced safety and assurance for users and operators.

Measurement Tolerances

Due to the properties and characteristics of the components above surfacing level, actual measurements may vary from those indicated in the diagrams. The manufacturer has established safe tolerances for these components.

Specifications

Assembly Time..... 1.5 hours
(after completion of ground excavation)

Personnel Required 3

Equipment

Dimensions are variable depending on your chosen installation.

Height..... 16 in (305 mm) Max

Use Zone..... 255 x 199 in Approx.
(6470 x 5050 mm) Approx.

Fall Height 12.0 in (305 mm) 2-5 years
16.0 in (406 mm) 5-12 years

Age Group 2 to 5 years or 5 to 12 years

Capacity 10

Foundations

Drainage Stone (total) 6.05 ft³ (0.172 m³) total
(4 inches of stone required at the bottom of each hole)

Note: Concrete is not required for installation of the Green Mamba.

Parts List

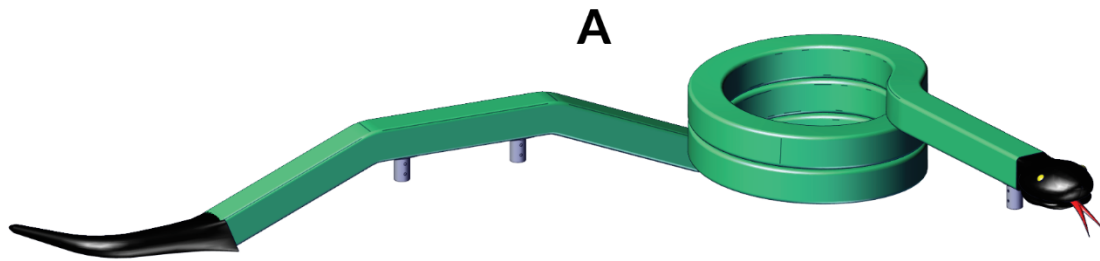

Part	Description	Qty
A	Green Mamba Rope Assembly	1
B	Post - 45.25 in Long	1
C	Post - 41.75 in Long	2
D	Baseplate	3
E	M16 Bolt and Washer	3
F	M10 x 75mm Bolt	6
G	M10 Acorn Nut	6
H	Compliance Stickers	2
I	Thread Locking Adhesive	1

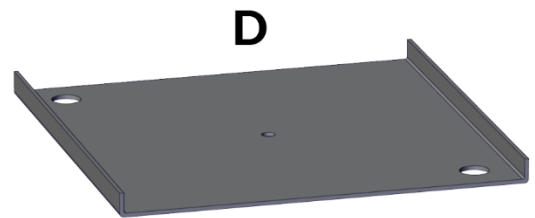
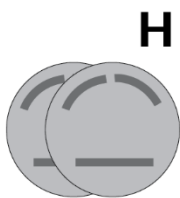
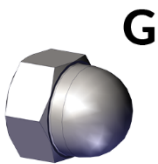
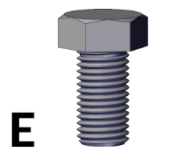
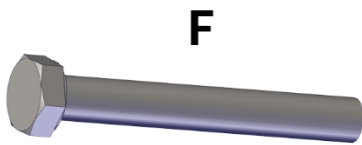
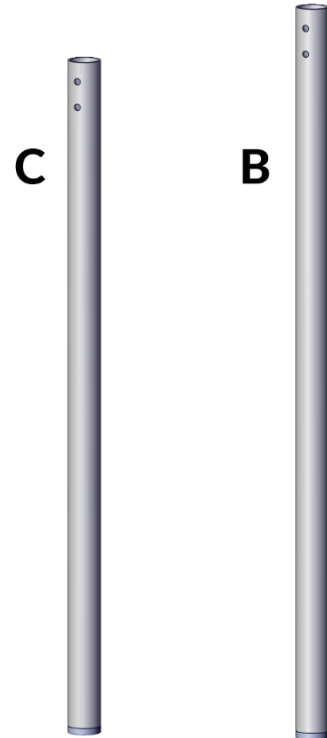

Installation

Part A: Site Prep and Use Zone

Be sure that the chosen site is well drained and level, with a 3% maximum slope.

A clear path and adequate protective surfacing are required 72 inches (1,829 mm) around the equipment.

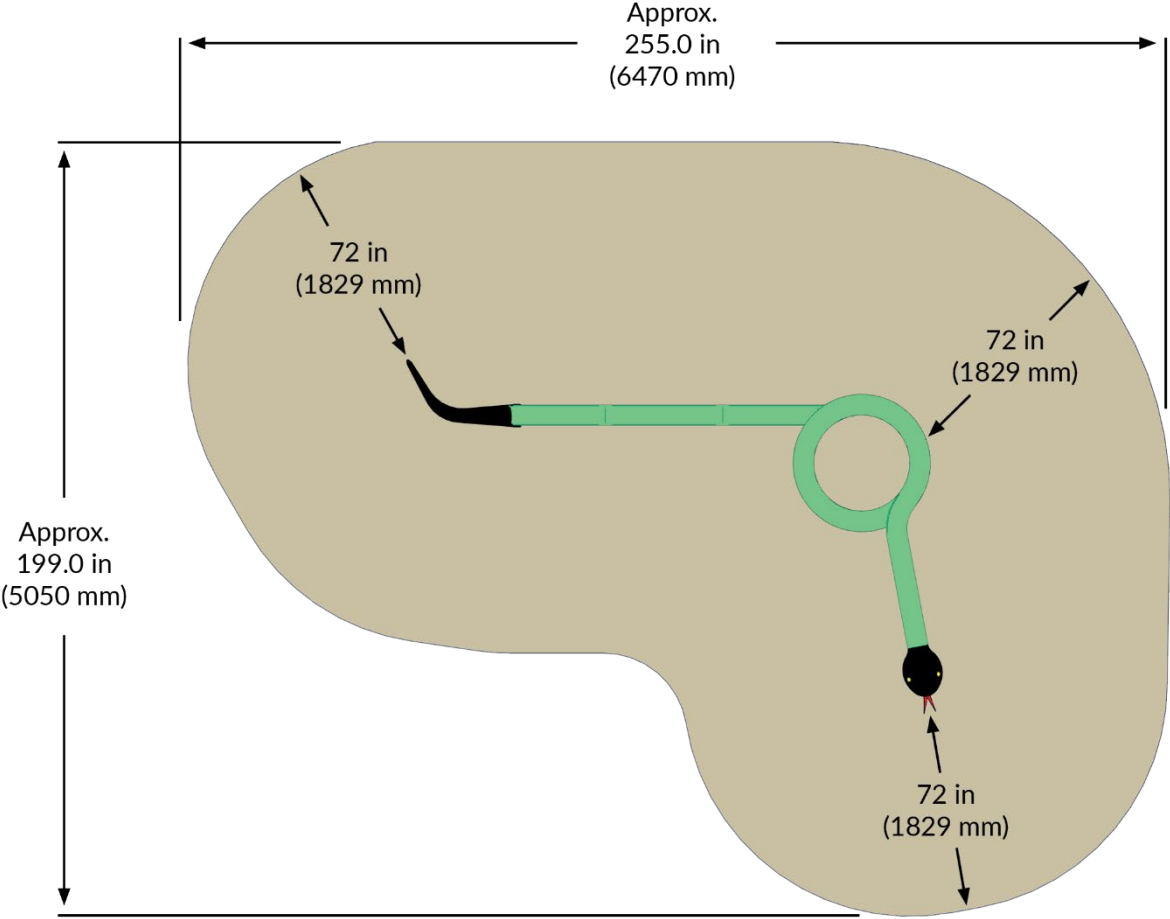

Installation

Part B: Anchor Posts

- Two holes are required to be excavated for installation of the three anchor posts. Use the diagram below to find the exact locations and dimensions of each hole.

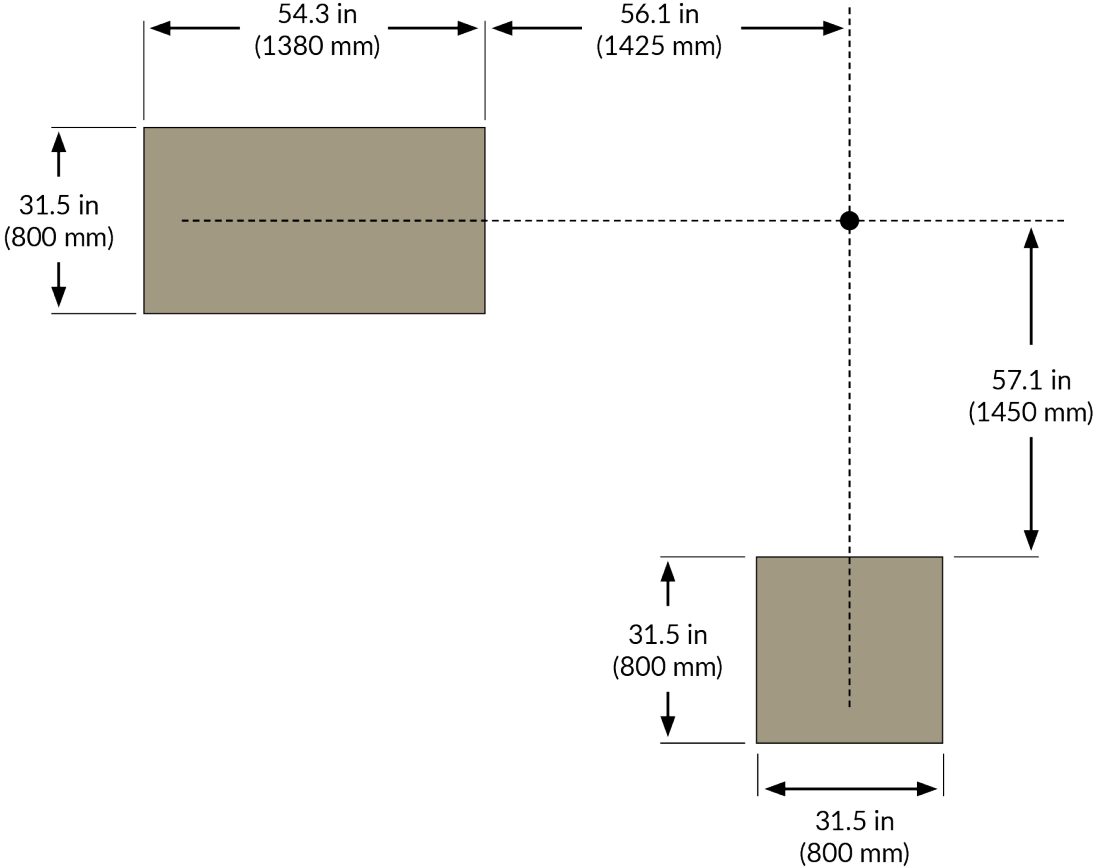

The Green Mamba may be installed at one of two different heights to comply with ASTM height requirements for age groups 2 to 5 and 5 to 12 years.

- Measured from the final intended surfacing height, dig both holes to the depth indicated in the appropriate diagram below, which includes 12 inches (300 mm) for surfacing over the dirt fill and 4 inches (100 mm) for drainage stone under the baseplate.

2 to 5 Year Age Group

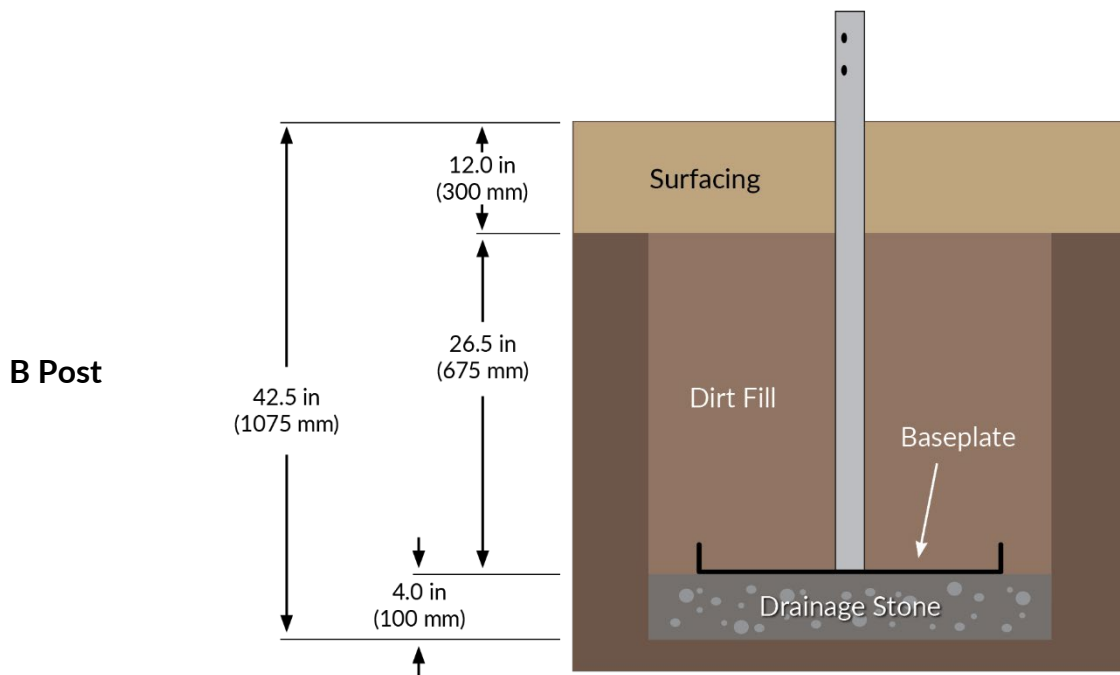
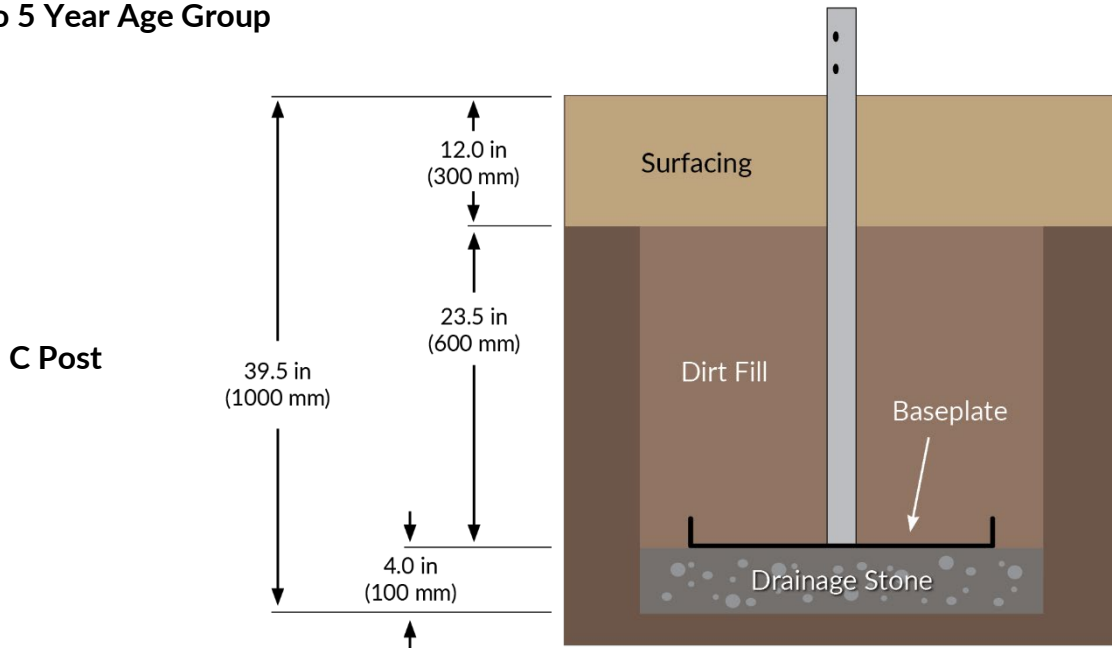

- Place 4 inches (100 mm) of drainage stone evenly on the bottom of each hole.
- Affix a baseplate (D) to the bottom of each post (B, C) using the M16 bolts and washers (E).

Note: Attach the baseplates with the side flanges pointing up.

- Mark the intended surfacing height on each post per the diagrams on the previous two pages, dependent on the desired age group.

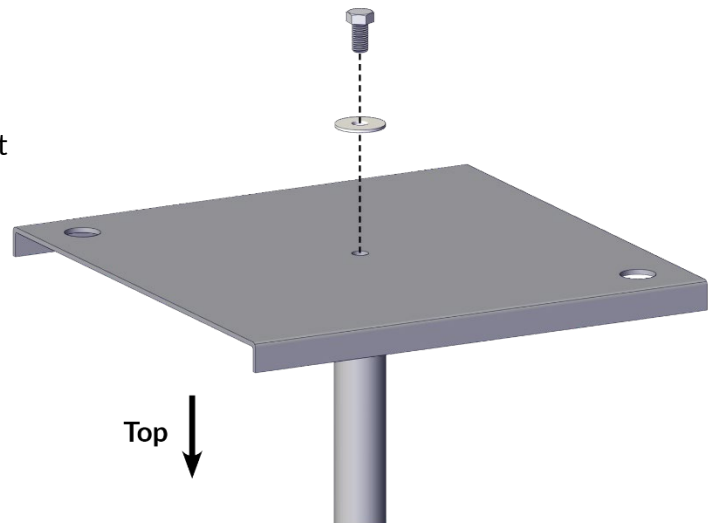

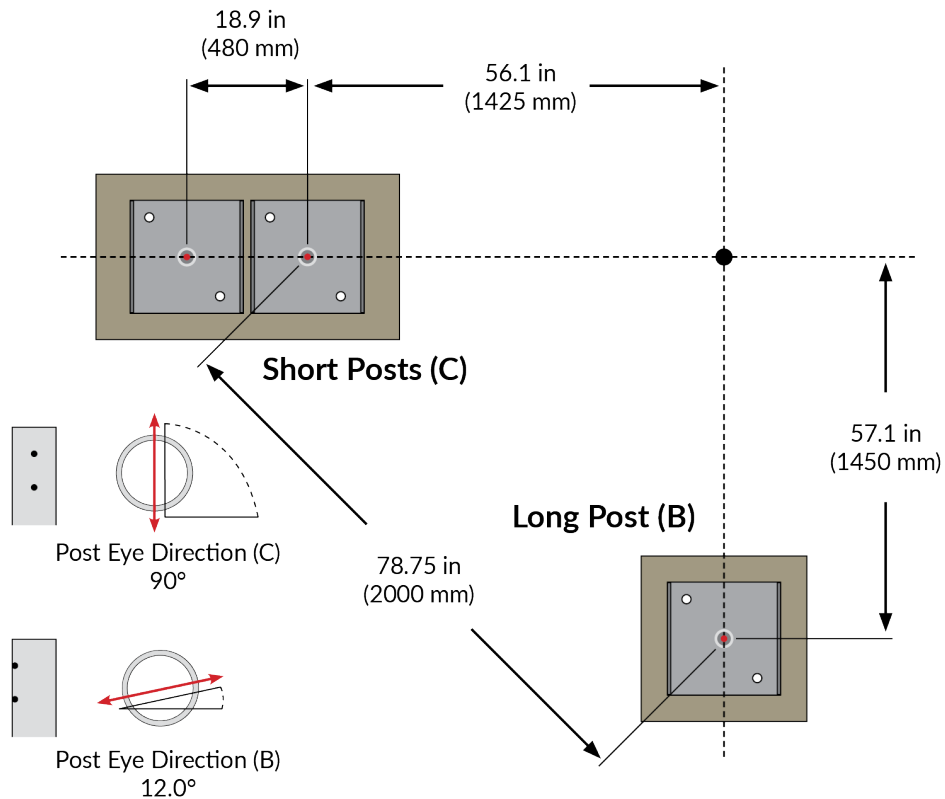

- Lower each post with baseplate into the holes at the positions shown so that the baseplate is resting flat on the drainage stone. Note the two different post lengths and their locations marked on the diagram above.



IMPORTANT: Note the direction of the post eyes. Be sure to rotate the posts on the baseplate until the eyes match the post eye directions above. This is to ensure that the post eyes align with the eyes in the post receivers installed to the bottom of the rope assembly.

- Adjust the drainage stone until all posts are straight. Measure between posts and adjust until the dimensions above are achieved.
- Pack dirt fill around the posts until the desired height is achieved. Compact dirt well.



Apply at least 5 drops of thread locking adhesive (I) to the threads of all nuts and bolts when installing. Do not apply thread locking adhesive to Acorn Nut (G).

In addition, the threads of stainless steel hardware must also be sprayed with Teflon spray or similar lubricant (not included) to prevent cold welding.

Stainless Steel Hardware

- **M10 Bolt and Acorn Nut**

Installation

Part C: Rope Assembly Installation

- Lay the Green Mamba rope assembly out over the posts, aligning each post to its corresponding receiver on the bottom of the rope assembly.
- Slide the receiver over the top of the post and align to the holes in the post.

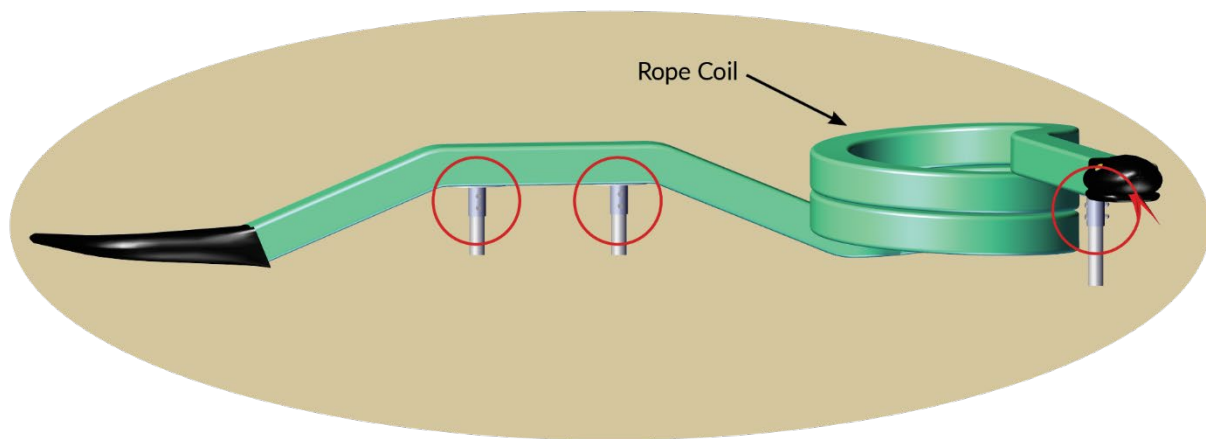

Coil Dugout

For compliance with ASTM, the height of the rope coil will need to be reduced – minimally for the 5-12 age group, and significantly for the 2-5 age group. A donut-shaped dugout must be excavated beneath the coil to recess it to a compliant height for safe play.

Note: Depending on the type and thickness of the surfacing material, it may be possible to achieve the required height without excavation or with minimal excavation. In this case, particularly with loose fill surfacing, the surfacing material may be spread around the Green Mamba until the compliant height is achieved. Please plan accordingly.

- Check the height of the rope coil. Per ASTM, for ages 2-5, the height must not be greater than 12 inches. For 5-12 years, the height must not be greater than 16 inches. The difference between the max height and the actual height of the coil, measured to the intended top of the surfacing, is the depth which must be excavated to recess the coil.
- Move the rope coil section away from the dig area and excavate to the required depth.
- Reposition the rope coil into the dugout and re-measure the height to the surfacing. Adjust as needed until the compliant height is achieved.

- Secure each connection with two M10 bolts (F) and two acorn nuts (G).

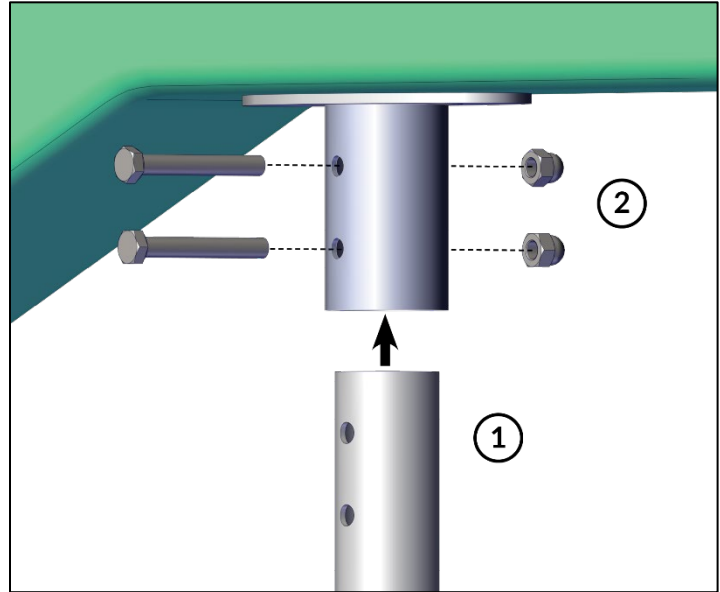

- Apply and grade protective surfacing material to the use zone per ASTM F1292.

Please refer to ASTM F1292, ASTM F1951, ADA, and ABA standards when choosing the type and thickness of surfacing material.



The minimum surfacing depth of 12 inches (300 mm) is critical to meet the manufacturer's specifications for safe use and compliance.

Finishing

- Place the two compliance stickers (H) onto the structure's posts – one on a post at each end of the structure in an accessible, visible location. Make sure the surface of the post is clean and dry before applying the stickers. These identification stickers are vital to maintaining compliance.
- Check the level of the surfacing. If using loose fill, mark the posts at the final level of the surfacing material so that the proper level of fill can be maintained. Ensure that no part of the Green Mamba exceeds the maximum height for your chosen age group: 12 inches for ages 2-5 and 16 inches for ages 5-12.
- Remove all tools, excess materials, or other assembly aids from the area prior to opening the equipment for play.

Final Checklist

Please make sure all following steps have been completed:

- () Checked that all connections are made and no hardware is loose.
- () Made sure the posts are level.
- () Applied all necessary surfacing and checked height measurements per ASTM F1292.
- () The product was installed to comply with ASTM F1487 or applicable local regulations.

Maintenance

To maintain safety, the operator must ensure that proper inspection and maintenance is carried out by a competent person in accordance with ASTM F1487 or CSA-Z614, and the following manufacturer recommendations.



Damage which may compromise safety must be repaired immediately. If repairs cannot be immediately carried out, the operator must close the equipment to prevent use.

Replacement Parts

Replacement parts may be obtained through your equipment dealer. Parts not obtained through a dealer must conform to the manufacturer's specifications.

Break-in Period

Between 1-2 weeks after installation (equipment break-in period), check all threaded connections and tighten if necessary. After the break-in period, the operator may follow the recommended inspection frequency.

Inspection Frequency

With average use and environmental conditions, check the following at or before the recommended frequency. If the equipment is exposed to regular high-use or harsh environments, the inspections should be performed at a shorter frequency. Inspections should also be completed per ASTM 1487 or CSA-Z614 guidelines.

Weekly

- Clear the internal coil area of any trash or debris.

Monthly

- Check all connecting elements and fittings for wear and tear and tighten if necessary. Repair or replace damaged or missing parts.
- Check surfacing for adequate depth and fill in as necessary.

Quarterly

- Check the stability of the foundations and post.

Yearly

- Check for corrosion on metal components. It may be necessary to dig out subterranean components to inspect them. Apply zinc paint to any corroded or scratched areas.

New Product Handover

Model Name: Green Mamba™
Model Number: 4591-81GM
Serial Number: _____

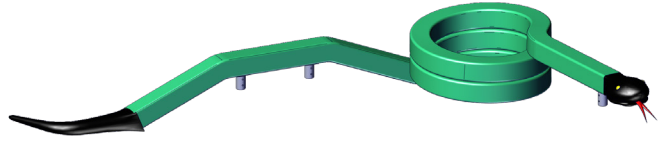

Operator

Name of operator (town, school, business, etc.): _____

Street: _____ City: _____ State: _____ Zip: _____

Representative in charge: _____

Installer

Name of installation company: _____

Street: _____ City: _____ State: _____ Zip: _____

Representative in charge: _____

Installer Checklist:

- Adequate concrete foundations poured per instructions.
- Structure assembled per the instructions without modification (unless approved by the manufacturer.)
- Final inspection conducted and passed per instructions.

Operator received the complete assembly instructions, inspection & maintenance instructions, and maintenance log. Installer completed work to the manufacturer's specifications.

Operator Signature: _____ Date: _____

Installer Signature: _____ Date: _____